

# Latte Art Factory Cleaning Manual

LAF Classic, LAF Bar  
August 2024

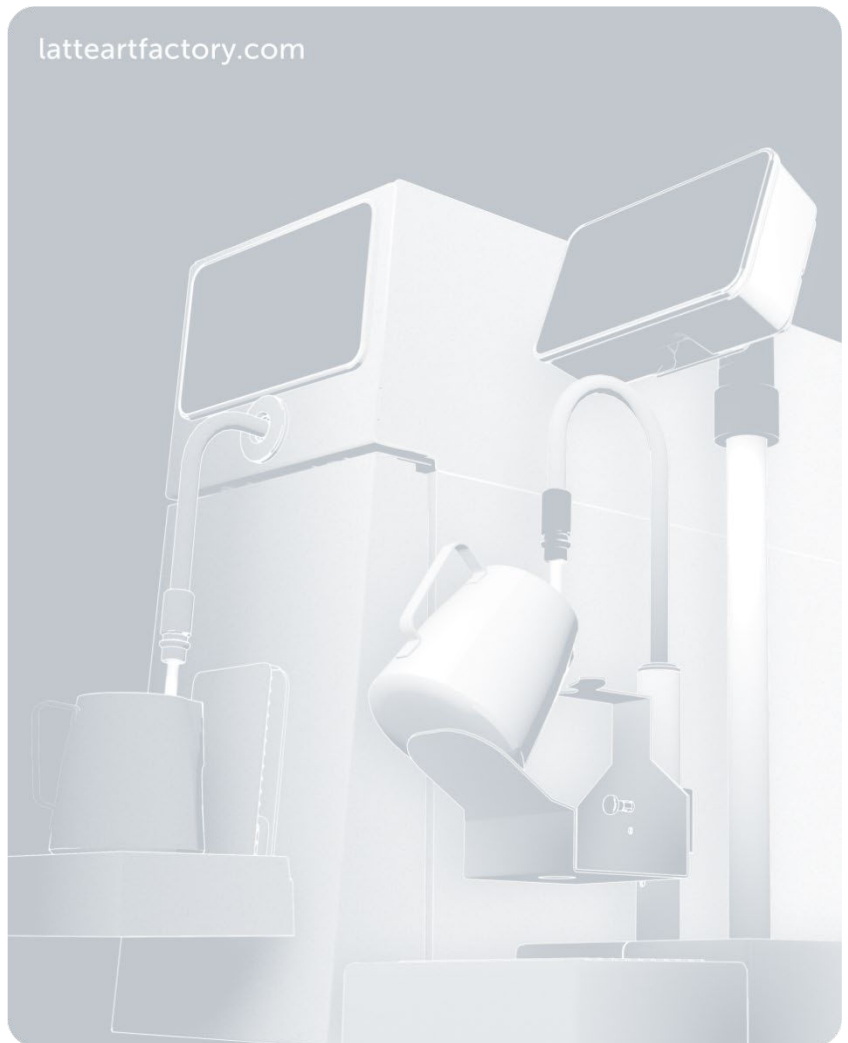

# Latte Art Factory Cleaning Manual



The Latte Art Factory must be cleaned after every day of use, or after 3 days of inactivity.

Accessories needed: cleaning adapter, Cup&Cino milk cleaning tablets, see below, cleaning container with the lid(s).



## Step 1

Remove the milk container(s) from the fridge and rinse with water.



## Step 2

Place one cleaning tablet on the lid as indicated and one more inside the container.



## Step 3

Put this container back into the fridge and push in firmly until you hear a click

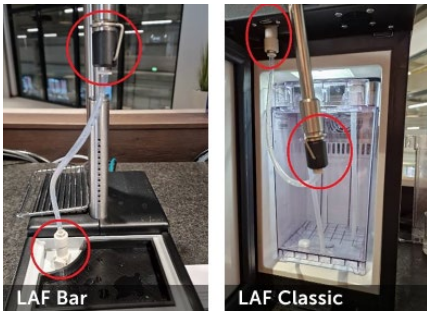

#### Step 4

Connect the cleaning adapter as shown in the pictures below. You will know that it is properly secured when you hear it click.

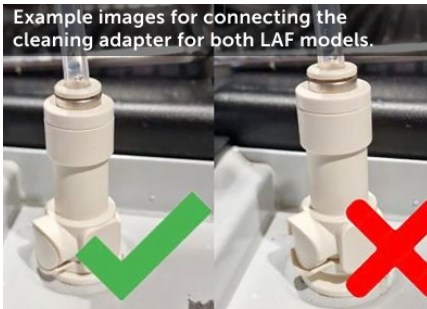

#### Note:

You will know that it is properly secured when you hear a click.



Make sure there are no gaps.



#### Note:

If you have a second fridge connected, please ensure that you plug in the cleaning tube as shown in the picture

**For 2nd custom fridge** (customer owned fridge connection kit)



**For Latte Art Factory 1 Gallon Refrigerator (2nd Fridge)**



#### Step 5

Open Menu > Service > Clean

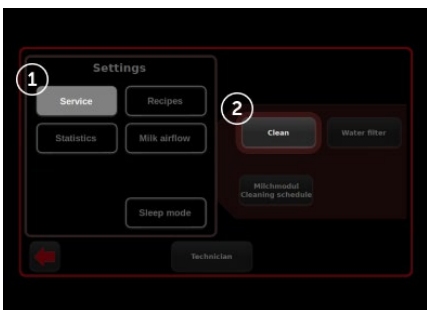



**Step 5**  
 Select “Cleaning Milk Module”.



**Note**  
 Press the green button.

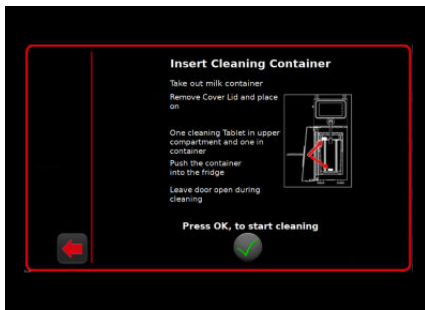

**Step 6**  
 Press the green button once again to confirm.

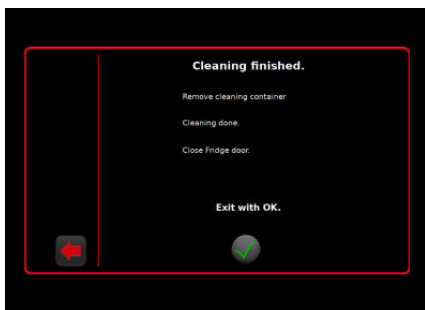

**Step 7**  
 Wait around 15-20 minutes for the automatic cleaning cycle to finish. Remove the cleaning adapter and container. Close the fridge door and press the green button.

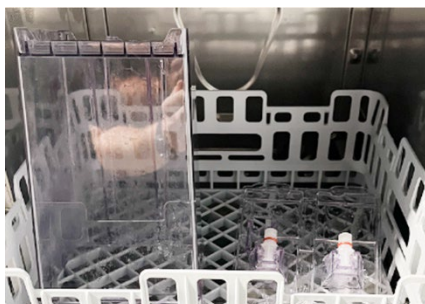

**Note**  
 Ensure that the container is always cleaned, either by hand or in the dishwasher at 70 °C / 158 °F (to avoid cracks in the plastic).

## CUP&CINO Cleaning Tablets Milk System

### 1. IDENTIFICATION OF MATERIAL AND SUPPLIER

Product Name	CUP&CINO Cleaning Tablets Milk System
Code	30415/ E10346
CLP unique formula identifier (UFI)	UR0E-GFT7-2102-YJ98
Product Use	For cleaning of milk lines and frothers in coffee machines
Company Name	CUP&CINO
Address	Paderborner Straße 33 D- 33161 Hövelhof
Telephone	+49 (0) 52 57 – 98 98 0
Email	<a href="mailto:info@cupcino.com">info@cupcino.com</a>
Emergency Numbers	Europe (112) Australia (000) United States (911) United Kingdom (999)

### 2. HAZARDS IDENTIFICATION

GHS Classification	Eye Damage 1- H318 (264+265,280 305+351+338, 337+317) Skin Irritation 2- H315 (264,280 302+352, 321,332+317,362+364) Skin Sensitiser 1- H317 (261,272,280 302+352,333+313,321,362+364) Acute Toxicity – Oral 4 H332 (261, 271 304+340,317)
Signal Word	DANGER
Hazard Statements	Causes serious eye damage Causes skin irritation May cause an allergic skin reaction Harmful if swallowed
Precautionary Statements	If medical advice is needed, have product container or label at hand. Keep out of reach of children. Wash hands thoroughly after handling. Wear protective gloves, protective clothing and eye/face protection. IF SWALLOWED: Rinse mouth. Call a POISON CENTRE/doctor if you feel unwell. IF IN EYES: Rinse cautiously with water for several minutes. Remove contact lenses, if present and easy to do. Continue rinsing. Immediately call a POISON CENTRE or doctor. IF ON SKIN: Wash with plenty of soap and water. If skin irritation or rash occurs: Get medical advice/attention. Take off contaminated clothing and wash before reuse.



Pictograms



**3. COMPOSITION / INFORMATION ON INGREDIENTS**

Ingredients	Name	CAS	Proportion
	Citric Acid	77-92-9	30-60%
	Maleic Acid	110-16-7	10-30%
	Sulphamic Acid	5329-14-6	1-10%
	Ingredients determined not to be hazardous	not required	Balance

**4. FIRST AID MEASURES**

<b>Ingestion</b>	If swallowed do NOT induce vomiting. Immediately wash out mouth with water. If symptoms develop seek medical attention.
<b>Eye</b>	If in eyes, rinse cautiously with running water for several minutes. Remove contact lenses, if present and easy to do. Continue rinsing. Continue flushing until advised to stop by the Poisons Information Centre or a doctor, or for at least 15 minutes.
<b>Skin</b>	If skin contact occurs, remove contaminated clothing and flush skin with running water.
<b>Inhaled</b>	Not normally a problem due to method of use and non-volatile nature of product.
<b>First Aid Facilities</b>	An eye wash fountain and general washing facility should be available adjacent to the work area.
<b>Advice to Doctor</b>	Treat symptomatically. For advice contact a Poisons Information Centre.

**5. FIRE FIGHTING MEASURES**

<b>Extinguishing Media</b>	Use appropriate extinguishing media to suit surrounding area.
<b>Hazards from Combustion</b>	Material does not burn. If involved in a fire, hazardous decomposition products include toxic gases and vapours.
<b>Precautions for Fire Fighters</b>	Wear chemical splash suit.
<b>Hazchem</b>	None allocated.

---

## 6. ACCIDENTAL RELEASE MEASURES

---

<b>Emergency Procedures</b>	Keep unauthorised people away. Do not touch or walk through spilled material. Do not touch damaged containers or spilled material unless wearing appropriate protective clothing.
<b>Clean Up</b>	Recover non contaminated material and place in containers for use. Recover waste material into separate containers and dispose of through licensed waste material operator. Use water to wash off remaining small amounts of residue from surface.

---

## 7. HANDLING AND STORAGE

---

<b>Handling</b>	Handle with care to prevent dust creation. Wash hands after use.
<b>Storage</b>	Store in a cool, dry, well-ventilated place out of direct sunlight. Store in original containers with lid on. Store away from incompatible materials such as chlorinated products.

---

## 8. EXPOSURE CONTROLS / PERSONAL PROTECTION

---

<b>Exposure Standards</b>	None listed for product.
<b>Engineering Controls</b>	Use in a well-ventilated area.
<b>Personal Protective Equipment</b>	Wear gloves and safety glasses or goggles if cleaning up spillage or handling large quantities

---

## 9. PHYSICAL AND CHEMICAL PROPERTIES

---

<b>Appearance</b>	White tablet
<b>Solubility in Water</b>	Soluble
<b>pH (neat)</b>	2.1 (1% solution)
<b>Flash Point</b>	Not available
<b>Melting Point</b>	Not available
<b>Boiling Point</b>	Not available
<b>Specific Gravity</b>	Not available

---

## 10. STABILITY AND REACTIVITY

---

<b>Stability</b>	Stable under normal conditions
<b>Hazardous</b>	Will not occur
<b>Polymerisation</b>	

Conditions to Avoid	No special conditions.
Incompatible Materials	Reacts with chlorinated products liberating chlorine gas.

---

### 11. TOXICOLOGICAL INFORMATION

---

Ingestion	Swallowing can result in nausea, vomiting, diarrhoea and abdominal pain. Can cause irritation to the mouth, oesophagus and gastrointestinal tract.
Eye	Highly irritating to eyes. Capable of causing pain and redness if not rinsed promptly.
Skin	Contact with skin may result in irritation, redness and itching.
Inhalation	Not normally a problem due to the physical nature of the product.
Chronic Effects	Prolonged or repeated exposure to this product to skin may result in skin irritation and possibly result in dermatitis.
Toxicological Data	Not available

---

### 12. ECOLOGICAL INFORMATION

---

Ecotoxicity	No information available. Avoid contaminating waterways, do not discharge to stormwater.
-------------	---

---

### 13. DISPOSAL CONSIDERATIONS

---

Rinse container after use and dispose of in general rubbish or in recycling bin.  
Refer to Waste Management Authority. Dispose of material through licensed waste contractor. Assure conformity with all applicable regulations.

---

### 14. TRANSPORT INFORMATION

---

UN No.	None allocated
Proper Shipping Name	None allocated
Hazchem Code	None allocated
Class	None allocated
Packing Group	None allocated

---

### 15. REGULATORY INFORMATION

---

Classification	This material is classified as hazardous according to criteria of Safe Work Australia and GHS Poisons Standard February 2023.
----------------	---



<b>Poisons Schedule:</b>	S5
<b>Hazardous according to the criteria of the Globally Harmonised System of Classification and Labelling of Chemicals (GHS)</b>	
<b>European Union</b>	Take note of Directive 98/24/EC on the protection of the health and safety of workers from the risks related to chemical agents at work.
<b>Additional Regulatory Information</b>	This SDS complies with legislative requirements in Australia, including Safe Work Australia guidelines, Australian Dangerous Goods Code and the criteria for the Globally Harmonised System (GHS) of Classification and Labelling of Chemicals.

## 16. OTHER INFORMATION

<b>Contact Point</b>	CUP&CINO Tel: +49 (0) 52 57 – 98 98 0
<b>Emergency Numbers</b>	Europe (112) Australia (000) United Kingdom (999) United States (991)
<b>Date of Preparation</b>	30 <sup>th</sup> May 2023

CUP&CINO Kaffeesystem-Vertrieb GmbH & Co. KG,  
Paderborner Str. 33, 33161 Hövelhof, Germany  
+49 5257 98 98 40 4, [www.latteartfactory.com](http://www.latteartfactory.com),  
[info@latteartfactory.com](mailto:info@latteartfactory.com)